

Adapt USB-C Charging Stations



ADAPT4-USBC, ADAPT6-USBC, & ADAPT12-USBC User Guide

Version B

#M00020

Last Modified 07/03/2024

For a copy of the most up-to-date manual, please contact a JAR Systems representative or visit:

JAR-Systems.com/Support



Quick Start

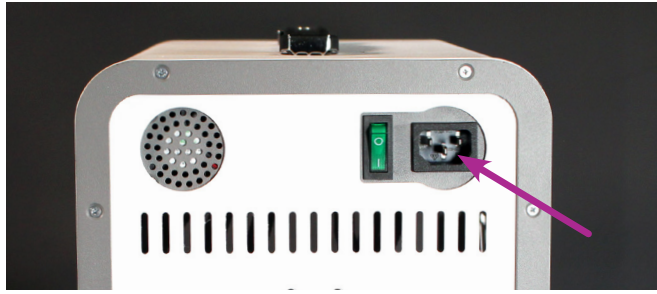

1. Connect station to power source and turn on the power switch
2. Plug in powered down devices
3. Connected devices will automatically charge as efficiently as possible
4. Connect/disconnect devices any time

LED Charging Port Indicator Lights

- White: Port Ready
- Blue: Device Charging
- Green: Charge Level >90%



Normal Operation

- Plug the power cable into a standard 15A outlet. Be sure that the power switch on the back of the station is in the ON position. LEDs will illuminate white to indicate the station is connected to a power source.
- Power off devices fully before connecting them to the station for charging.
- Connect the devices to the USB-C charging cables. Ensure that devices are placed in the station so that the charging ports are as close as possible to the USB-C charging port on the station. **Incorrectly connecting devices can strain the cable over long periods of time and lead to damage.**
- The LED lights will change color according to the power draw of the attached devices.
- The system will automatically limit power consumption per USB-C port to avoid overconsumption. Refer to the device for the level of charge. Connected devices will charge as quickly and evenly as possible without drawing too much power.

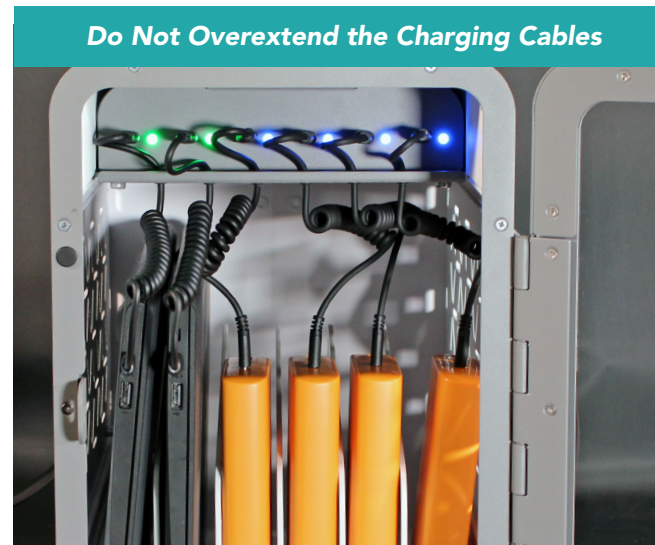

- To remove devices from the stations with the greatest level of charge first, disconnect devices with the green LEDs first before you disconnect devices with the blue LEDs.

Options

Other Charging Port Types

Devices that utilize charging port types other than USB-C can be charged in the stations with the use of USB-C emulator cables. Emulators are available from JAR Systems for most common charging port types. (Not Included, contact JAR Systems for more info)

Removable Door

The door of the station can be removed for easy access to devices. Use the supplied box wrench to loosen the two screws located on the inside of the station frame.

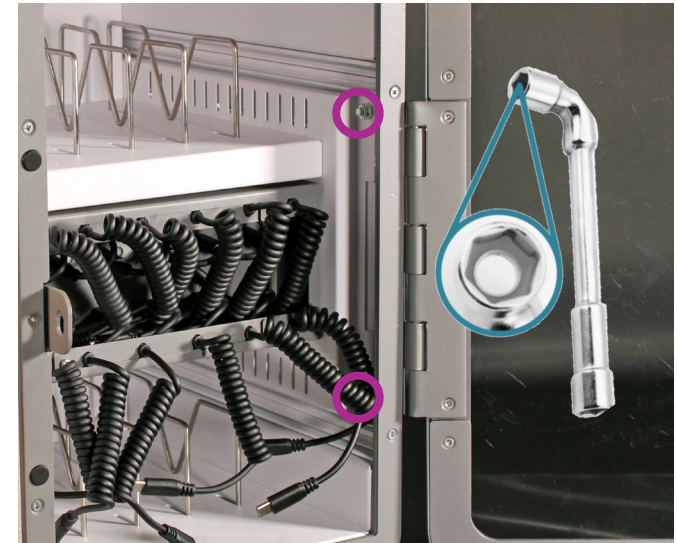

Trouble-Shooting

Preventing the Station from Being Transported

Adapt stations feature a Kensington® Security Slot™ and a loop on the back which enables users to utilize a locking cable to secure it in place. (Locking cables not included)

Wall Mounting Bracket

Mount the bracket using included hardware to fasten the taller side of the bracket to the wall. Attach the provided hardware to one side of the station for it to slide into notches in the mounting bracket and secure into the bracket the with the screws through the front. (Optional, not included)

WARNING: Failure to provide adequate structural strength for this mounting system can result in serious personal injury or damage to equipment. It is the installer's responsibility to make sure the structure to which this mounting system is attached can support five times the combined weight of all equipment. Reinforce the structure as required before installing the mounting system. Always ensure that proper hardware is used for the wall surface type. Never operate this mounting system if it is damaged. Contact JAR Systems for replacement or repair.

Always start troubleshooting with a simple reboot

Turn the station off and then on again using the switch on the back. When the station is connected to power, the LEDs will change color based on the power draw of connected devices (see light indication).

Single Port or Device Issue

Ensure that both of the USB-C cable ends plug into the station and the device correctly.

If there is still no charge, disconnect the device from that port (A) and plug into another port (B). If it is still not charging, it may be an issue with the device.

If charging begins when using port (B), exchange the cable from port (B) to port (A). If it begins to charge, the cable (A) is defective and will need to be replaced.

Entire Charging Hub/Shelf Issue

Check the back of the station to see if the power switch is in the ON position and the power cable is plugged in and connected correctly.

When the station is powered back on, the LED lights will begin to illuminate.

Remove/Replace USB-C Cables

Each cable lock bar may be secured with up to two screws. Remove all screws with the supplied T10H Torx key (Adapt12) or by hand (Adapt4 & Adapt6). See the chart below for details.

Remove the cable lock. Unplug the cables from the USB-C ports and route them through the cable track.

Reverse the process to replace a cable.



REMOVING THE CABLE LOCK BAR(S)



ADAPT12 USB-C CHARGING STATION

Features an upper a lower cable lock bar, each secured with two T10H Torx screws.



ADAPT 4 USB-C & ADAPT6 USB-C CHARGING STATIONS

Features one lock bar secured by two thumbscrews.

Warnings

- Power down all devices prior to connecting them to the hub for charging.
- Keep away from moisture and harsh chemicals. Do not place any liquids near the charging station.
- Any electrical equipment must be used by an adult or with adult supervision.
- Do not connect unsupported items to the charging station or use for any purpose other than its intended use.
- Do not attempt to obstruct any ventilation openings or dismantle, open, or modify the system in any way.
- Do not sit or stand on the station or charging hub.
- Do not use an extension cable or daisy-chain to any other devices.
- Not intended for operation at altitudes greater than 2000 m or 6561 ft above sea level and should not be operated in extreme temperatures. For indoor use only.

Disclaimer

Failure to read, thoroughly understand, and follow all instructions can result in serious personal injury, damage to equipment, or voiding of factory warranty. Since the use of this information, the equipment connected, and the conditions by which any JAR Systems product is used is beyond the control of JAR Systems, it is the obligation of the owner and/or user to determine the correct and safe use of any equipment and product. To the extent that the law permits, any liability which may be incurred as a result of the use or future use of a product manufactured or sold by JAR Systems is limited to the cost of repairing or replacing the failed product or component at the discretion of JAR Systems either within, or outside of warranty periods, and does not extend to any loss or damage which may be caused as a consequence of misuse or failure of the equipment, product or the information contained herein. JAR Systems shall not in any event be liable for economic loss of profits, indirect, special, bodily injuries or consequential damages. Specifications and images are for illustration purposes only. Final product may differ and is subject to change without notice.

JAR SYSTEMS

Warranty

This product comes with a warranty that covers any defects in material or workmanship and extends to the original consumer of the product only. JAR Systems, LLC will replace the product with a new or refurbished product, repair the product, send replacement parts, or refund the purchase price of the product, at JAR Systems, LLC's discretion. This warranty does not cover accidental damage, unreasonable use, neglect, tampering or other causes not arising from defects in material or workmanship.

Any implied warranties last only as long as the warranty periods listed above except where state law does not allow limitations on how long an implied warranty lasts. This includes but is not limited to the implied warranties of merchantability and fitness. JAR Systems, LLC's responsibility is limited to the actions listed above and nothing else.

This warranty does not cover, and JAR Systems, LLC will not be responsible for, any damages due to loss of use of the product, or any other costs or expenses incurred by you or anyone else who uses the product, whether due to defects, breach of contract, negligence, strict liability or otherwise. JAR Systems is not liable for any indirect, special, incidental or consequential damages related to the product or this warranty. Some states do not allow exclusions or limitations on consequential or incidental damages, so these limitations or exclusions may not apply.

This warranty gives you specific legal rights and you may also have other rights that vary from state to state. This warranty is governed by the laws of Florida, excluding its conflict of laws principles, unless your state requires that its law be used.

Contact JAR Systems for information on the length of warranty on your product(s).



Explore more options for USB-C Charging!

Learn about ways to charge devices in growing technology landscapes. Contact a JAR Systems representative at 866.393.4202 or visit:

JAR-Systems.com/Products